



CITY OF BEAVERTON

CITY ORDINANCES

ORDINANCE #3770 - CODE - AMENDS 9.05.035 - PERMIT APP

REQUIREMENTS FOR FLOODFRINGE PROPERTIES W/IN DRAINAGE IMPROVEMENT
TASK FORCE STUDY AREA.

NUMBER OF PAGES 16

CODE

ORDINANCE NO. 3770

AN ORDINANCE AMENDING THE BEAVERTON CODE, SECTION 9.05.035, TO AMEND THE PERMIT APPLICATION REQUIREMENTS FOR FLOODFRINGE PROPERTIES WITHIN THE DRAINAGE IMPROVEMENT TASK FORCE STUDY AREA.

WHEREAS, in 1982 the City appointed a Drainage Improvement Task Force (DITF) to study the implications of fill placed in the floodfringe in the area between Canyon Road and Murray Boulevard as a result of the reduction in the floodplain in those areas following the Murray Culvert and GM spur improvements; and

WHEREAS, the DITF recommended that unlimited fill be allowed in the floodplain fringe on those properties which participated in the Murray Culvert LID between Canyon and Murray due to the lowering of the floodplain in that area; and

WHEREAS, this recommendation results in the maximum development potential and flexibility to properties in this area while still protecting the City from the hazards of flooding; and

WHEREAS, the DITF recommendation addresses flooding issues only and does not address other considerations relative to fill such as water quality, erosion control, or wetland values; and

WHEREAS, the DITF recommendation was presented to the City Council on May 17, 1982 and was accepted, but the Beaverton Code was never amended to reflect this decision; and

WHEREAS, recent development applications in this area have brought to the attention of the City's Community Development and Public Works Department the need to amend the Beaverton Code to implement the Council's direction and promote consistency and certainty in the City's development review process; now, therefore,

THE CITY OF BEAVERTON ORDAINS AS FOLLOWS:

ORDINANCE NO. 3770

The Beaverton Code, section 9.05.035F, is amended by the addition of a new subsection 3 to that section as follows:

"3. The requirements of section 9.05.035F(2)(a) above do not apply to properties located from Canyon Road to Murray Boulevard to the extent that the application for development proposes fill in the floodfringe and to the extent the affected property participated in the Murray Culvert LID. The remaining provisions of this Code remain in effect as to those properties, which are described in Ordinance No. 3284".

A map of the affected parcels is attached hereto as Exhibit "A".

First reading this 18th day of March, 1991.

Passed by the Council this 1st day of April, 1991.

Approved by the Mayor this 4th day of April, 1991.

ATTEST:

APPROVED:

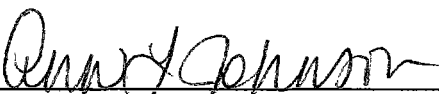

ANN L. JOHNSON, City Recorder

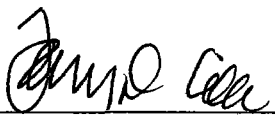

LARRY D. COLE, Mayor

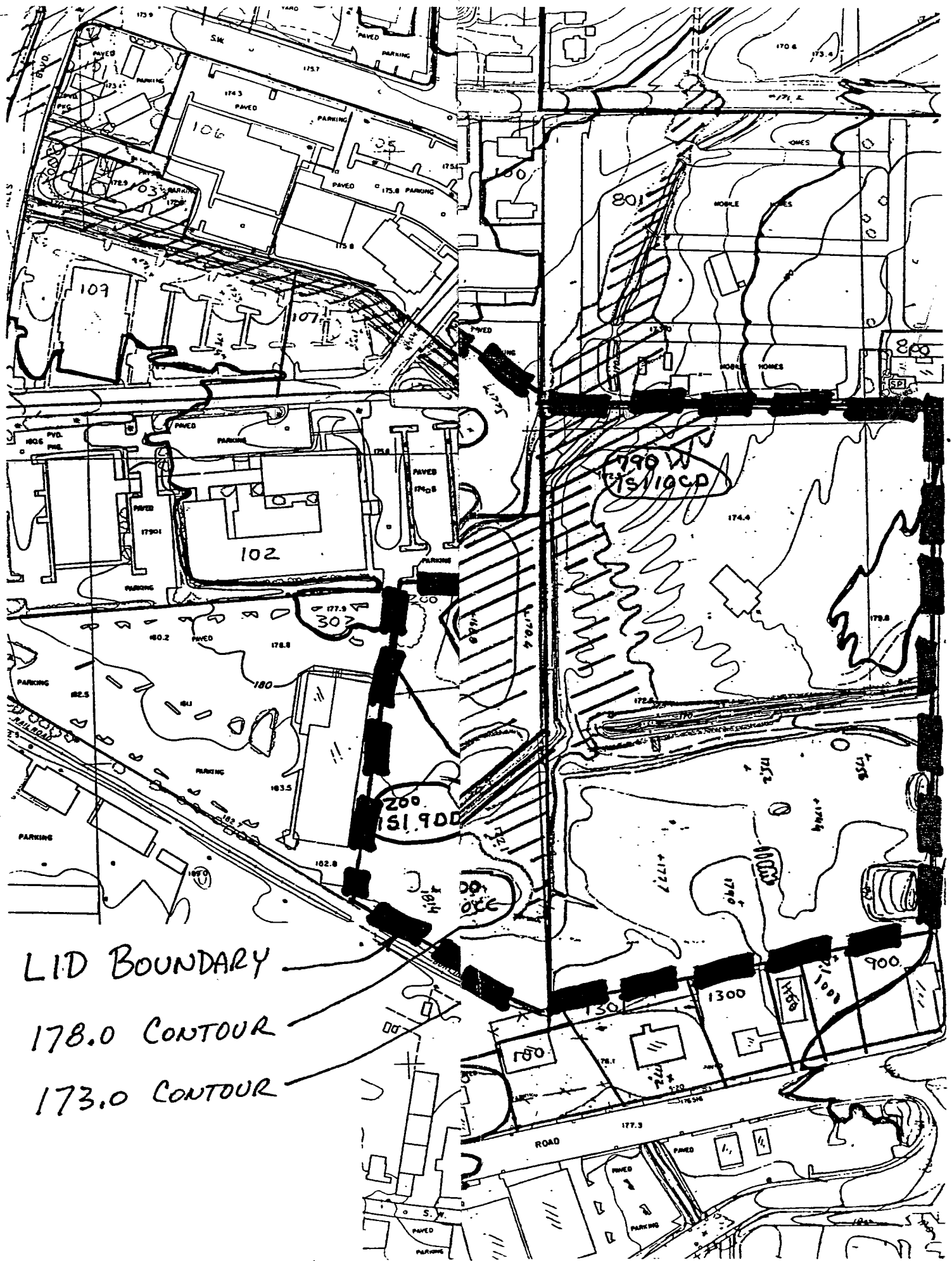

LID BOUNDARY
178.0 CONTOUR
173.0 CONTOUR

EXHIBIT A

MURRAY ROAD CULVERT LID

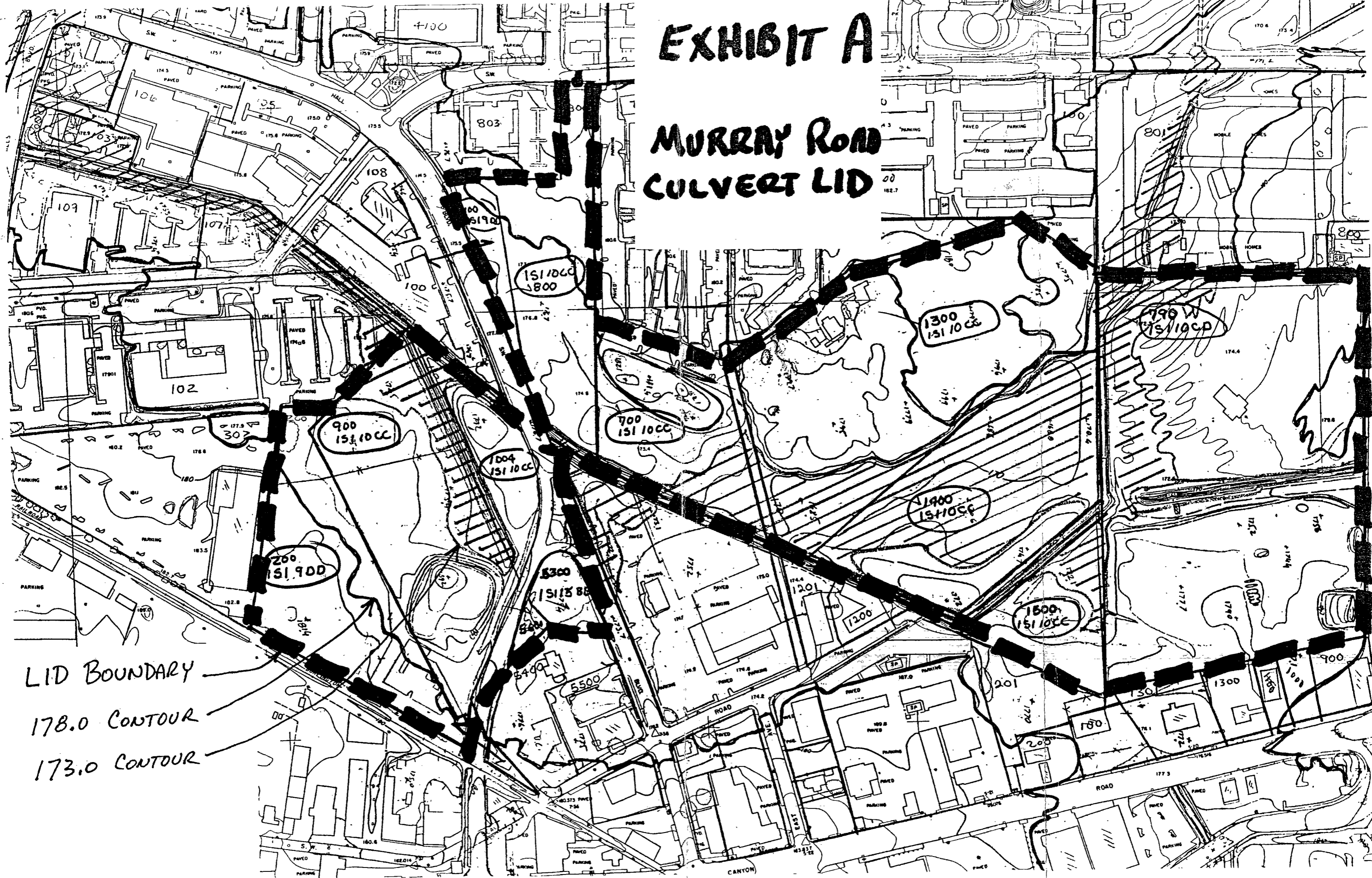

LID BOUNDARY
178.0 CONTOUR
173.0 CONTOUR